

THE CEMETERY OF THE GATE OF HEAVEN MOUNT PLEASANT, N. Y. SECTION 48

Nov. 1933.

PROPERTY OF
THE TRUSTEES OF ST. PATRICK'S CATHEDRAL
THE CITY OF NEW YORK

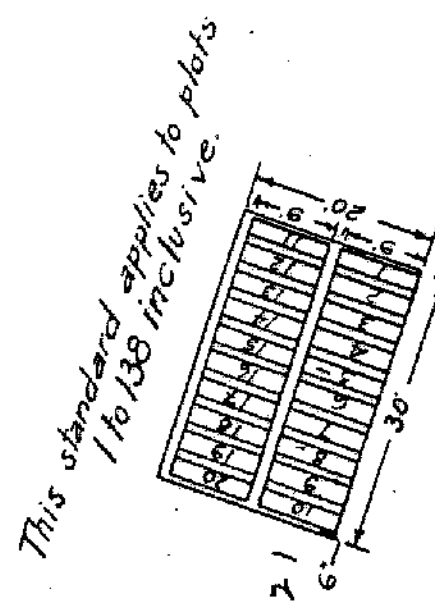

Note: The layout of this section is on the same plan as the plan of Section 47. The plots will be permitted for burials. Not more than two graves will be erected in any one plot. Only one monument may be erected on a graveholding. A graveholding means such grave or graves as are designated on the plan. If a family secures a graveholding for a plot, such graveholdings may not be marked with corner posts to give the semblance of a family plot. Corner posts may not be placed in this section. Do not place any monument for a monument in this section without the approval of the Board of Trustees.

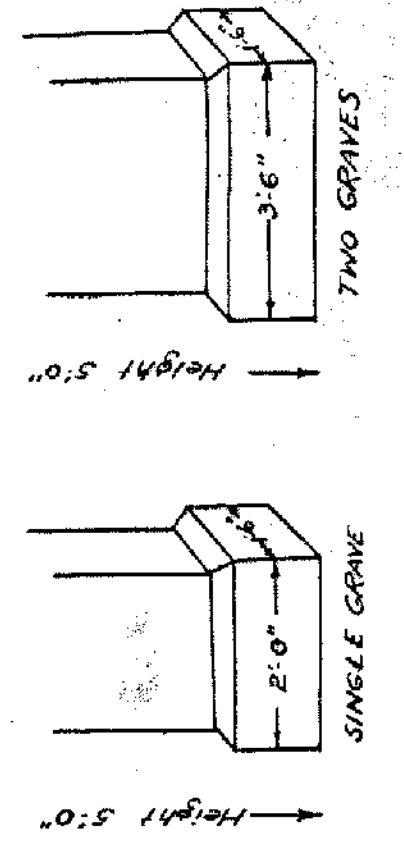

Monument in this section may exceed dimensions shown above.

Approved
Meeting
9th Nov. 1933

Charles E. ...
Supt. - Engineer

For ...
Managing Director

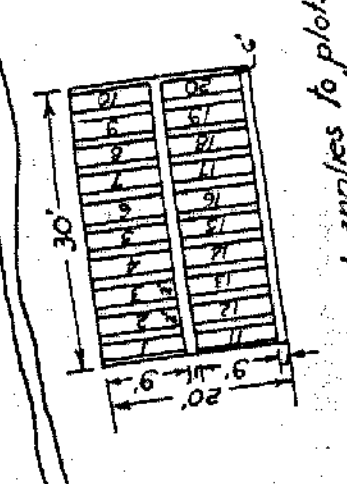

This standard applies to plots
16.135 inches by 16.135 inches.