

Headstones may consist of not more than two pieces.
 No monument in this Section may exceed 4' in height, except where the monument is strictly a cross design, then a 5' height may be allowed.
 The width of the base may not exceed 1'-6" and the length of the base may not exceed two-thirds the width of the graveholding.

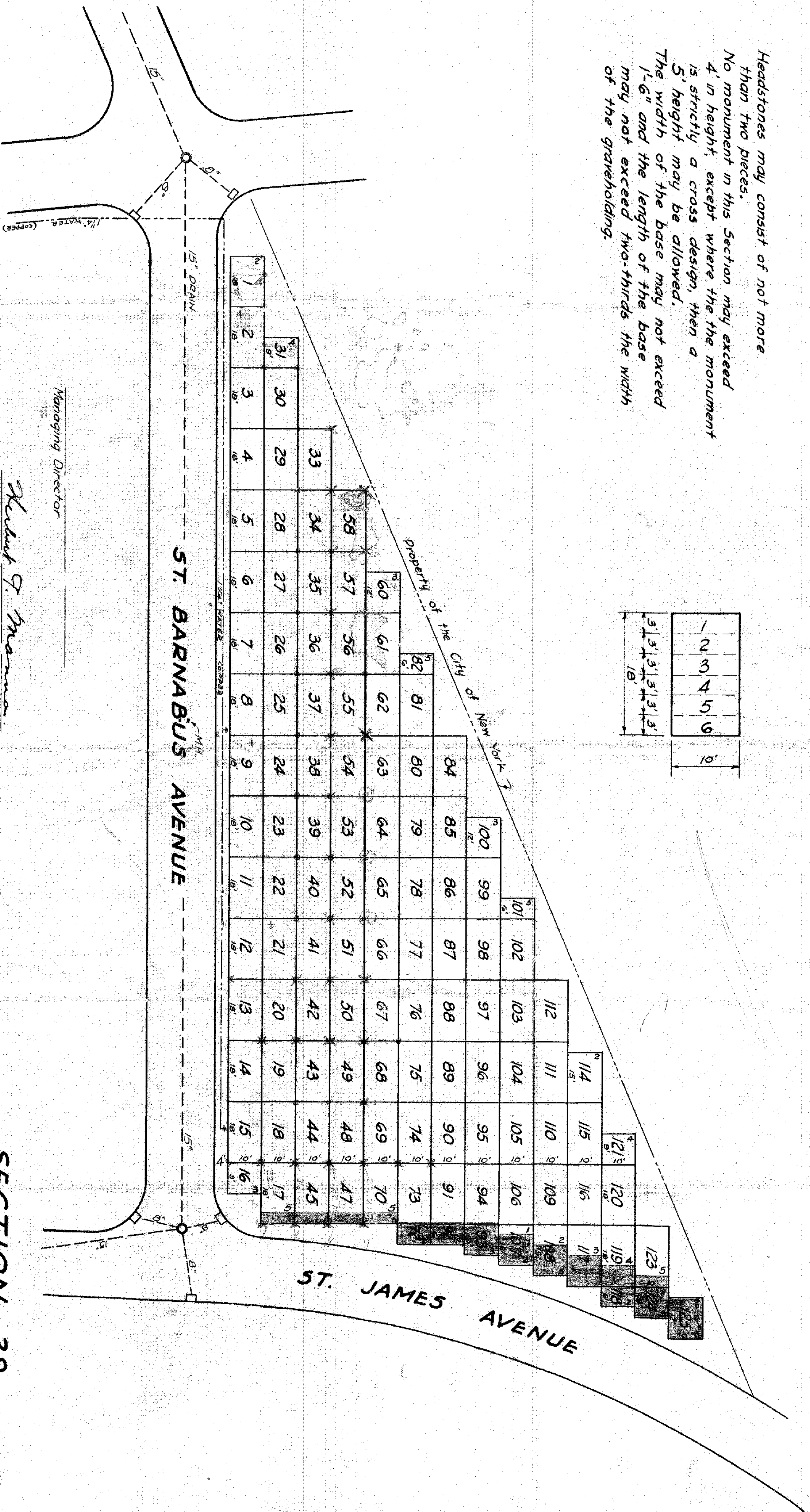
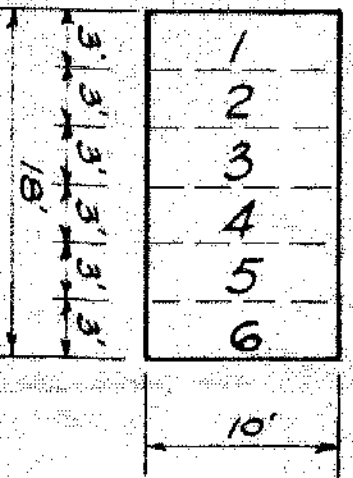

SECTION 39
CEMETERY OF THE GATE OF HEAVEN
HAWTHORNE, NEW YORK.

Scale — 1" = 20'

Chief Cemetery Clerk

Richard G. Marano
 Supt. Engineer

Managing Director

662 Graves.

MARCH-12-1957

V.L. ANDREWS, ASST. ENGINEER