

**REGULATIONS FOR SECTION 23**

Upright monuments are permitted on plots numbered from 126 to 224, inclusive.

Minimum sale in the upright monument areas shall be two graves.

Upright monuments shall not exceed the following dimensions. Length -  $\frac{2}{3}$  width of lot

Width - 1'-4"

Height - 3'-0"

On all other graves, only GRANITE FLUSH MARKERS will be permitted having the following dimensions.

2'-0" x 1'-0" x 0'-4"

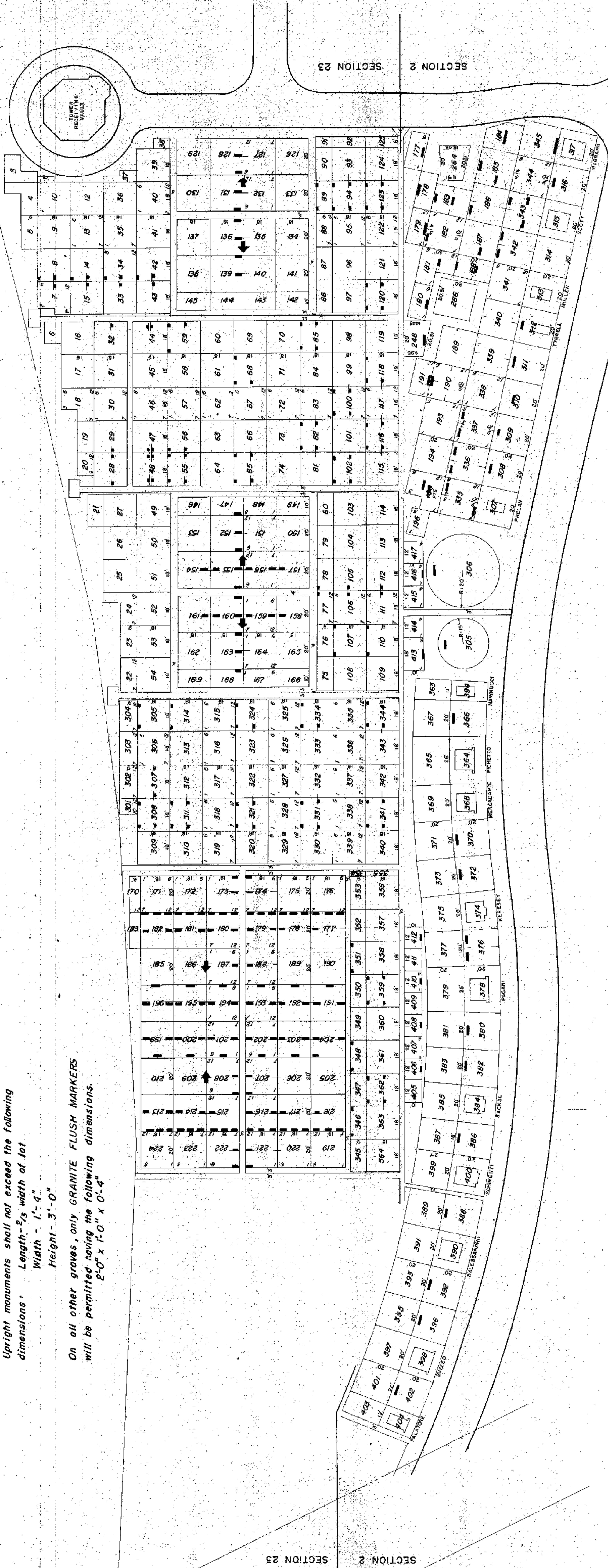

**PART PLAN  
SECTIONS 2 & 23  
CEMETERY OF THE GATE OF HEAVEN  
HAWTHORNE, N.Y.**

SCALE: 1" = 20'

APPROVED: *Edward J. Muth*  
BY REV. MGR. EDWARD J. MUTH  
MANAGING DIRECTOR  
*Herbert T. Mania*  
HERBERT T. MANIA  
SUPERINTENDENT - ENGINEER