

65

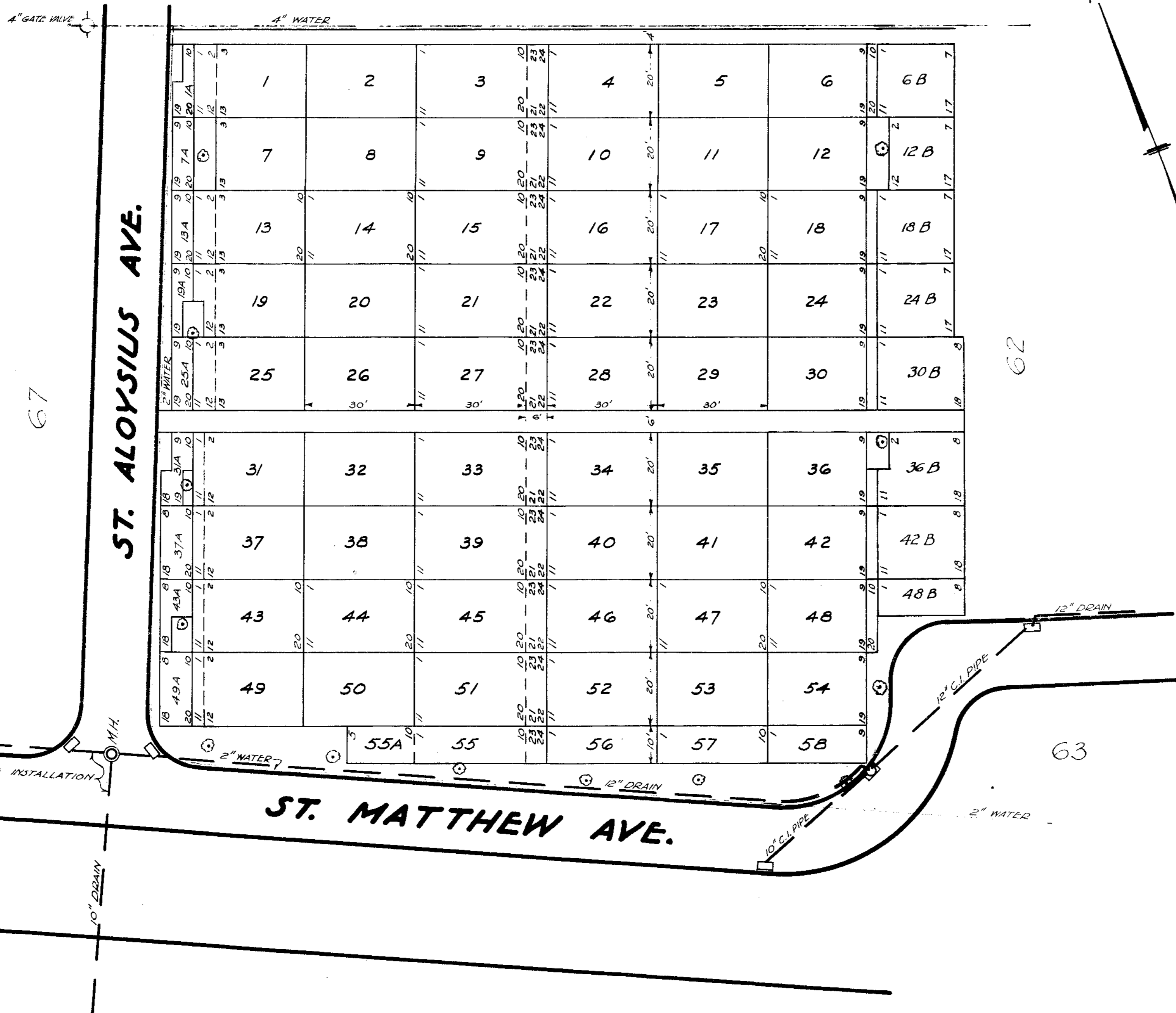

67

62

63

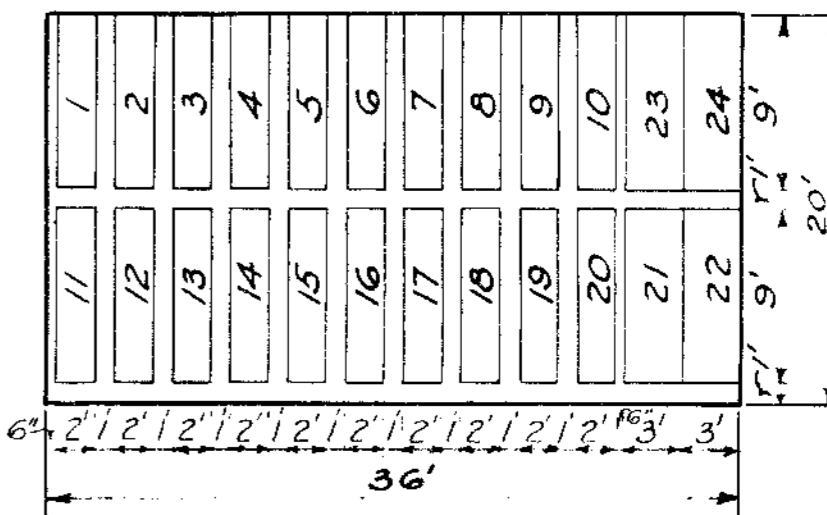
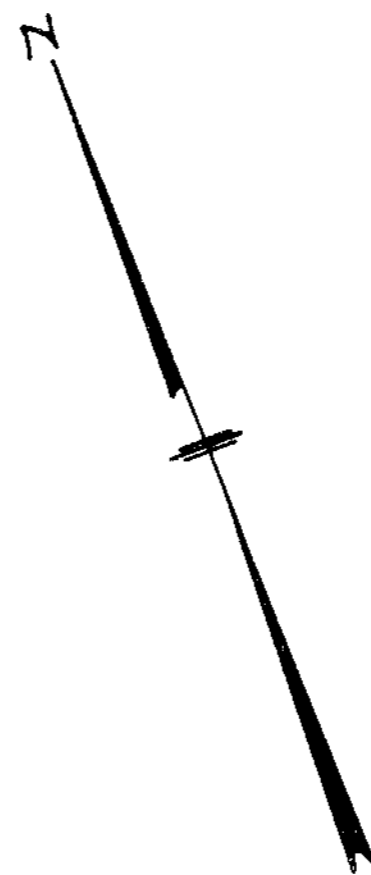

Note: Plots are numbered 1 to 58 and are divided into single graves numbered 1 to 20, each 9'x2' with one foot of space intervening. Graves numbered 21 to 24 incl. each measure 9'x3'.

RT REV. *Russell B. Fisher*
 Managing Director Superintendent

Harry J. Haulon *John T. Kearney*
 Engineer Chief Cemetery Clerk

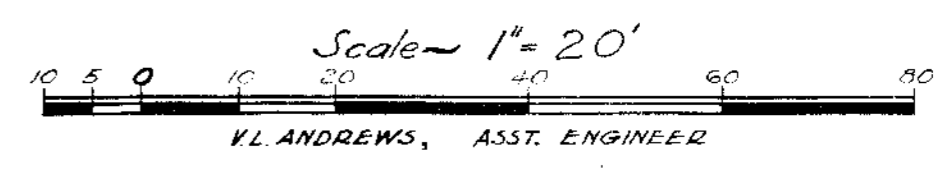

PROPERTY OF THE TRUSTEES OF ST. PATRICK'S CATHEDRAL IN THE CITY OF NEW YORK.

**CALVARY CEMETERY
 ST. DOMITILLA DIVISION
 SECTION 66**

Original Map Dated March 1930
 REVISIONS
 Nov. 1935 H.T.M.
 March 1951 V.L.A.
 Jan. 1961 H.J.H.