

PROPERTY
OF
THE TRUSTEES OF ST. PATRICK'S CATHEDRAL
IN
THE CITY OF NEW YORK

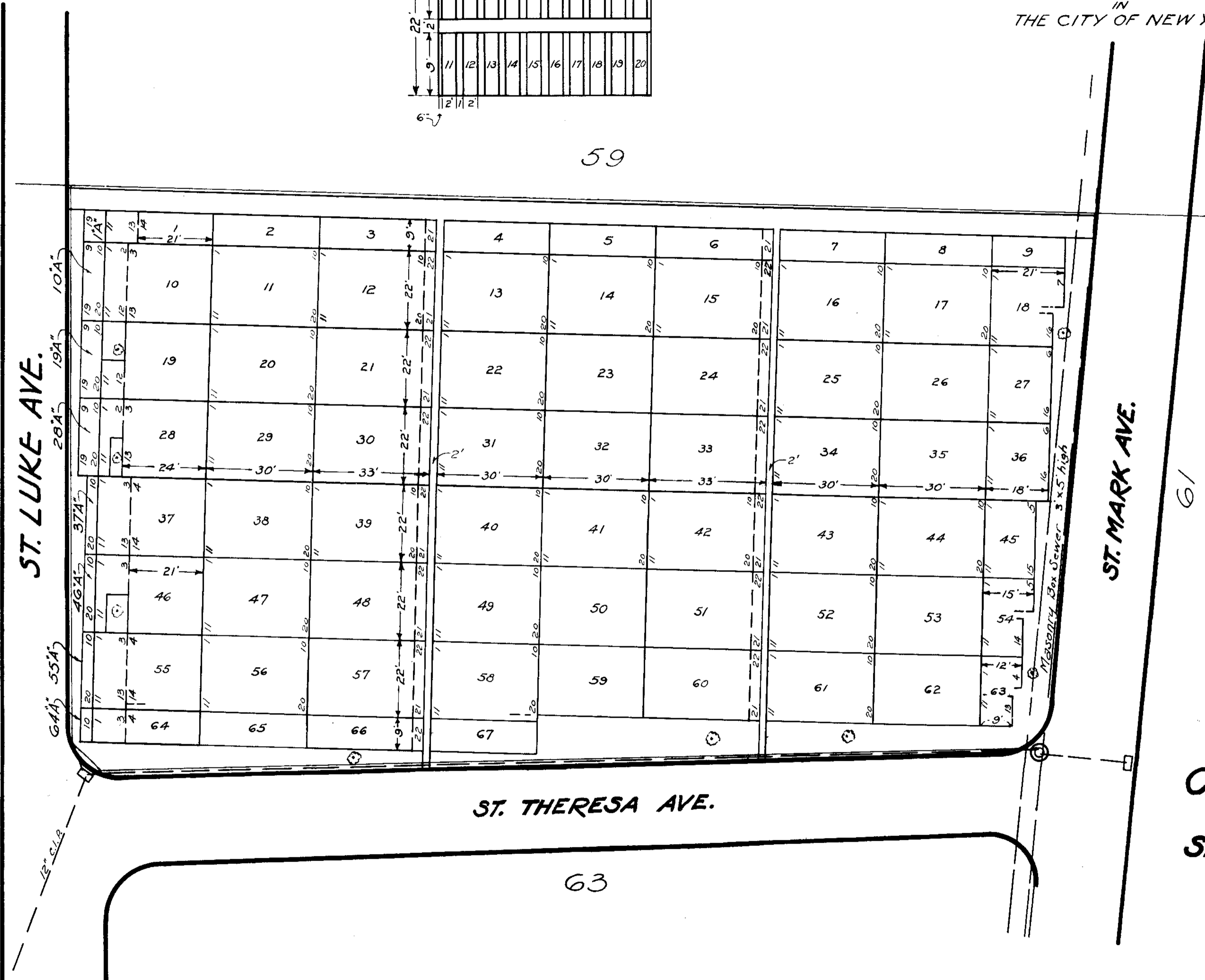
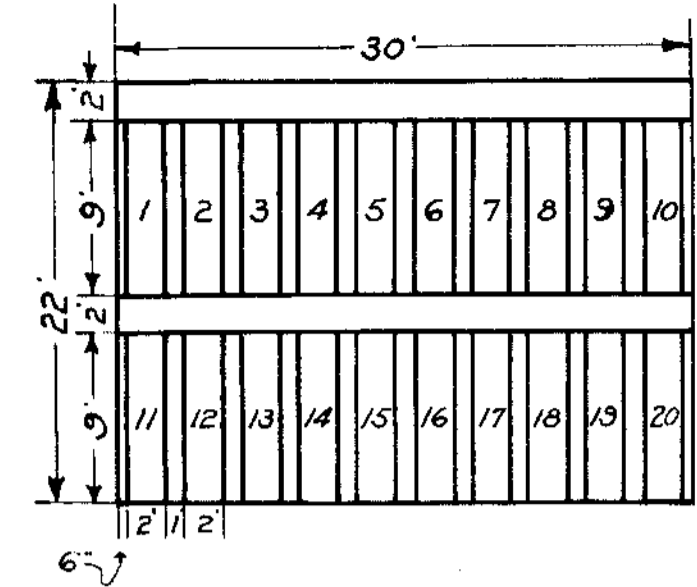

Note:
Plots are numbered from 1 to 67, divided into single graves 9' x 2' with one foot of space intervening.

Note:
Paths in this section are to be of concrete, but not for entire width. In 5 ft paths, 4ft is to be of concrete, allowing 6" clear on each side.

Alfred C. Dineen
Managing Director

J. J. Cunningham
Superintendent

Samuel S. Giffi
Engineer

Nancy J. Hannon
Asst. Engineer

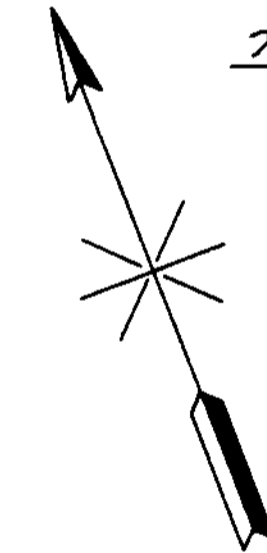

ST. DOMITILLA DIVISION
CALVARY CEMETERY
SECTION 62
SINGLE GRAVE SECTION



October, 1928.