

PROPERTY  
OF THE  
**TRUSTEES OF ST. PATRICK'S CATHEDRAL**  
IN THE  
**CITY OF NEW YORK**  
New York Office - 24 East 52<sup>nd</sup> St.

V.L. ANDREWS, ENG.

Vertical columns, called Ranges, are numbered 1A, and 1B, 17 inclusive. Ranges are subdivided into Plots lettered A to M, 1 and 11 being omitted.

Plots in Ranges 1A, 1, 13 (A to EE), 14 (A & EE), and 17 (A to 11) are subdivided into graves as in the following diagram:

Plots in Ranges 2 to 12 inclusive, 13 (FF to KK), 14 (FF to KK), 15, 16, and 17 (U to JJ) are subdivided into graves as in the following diagram:

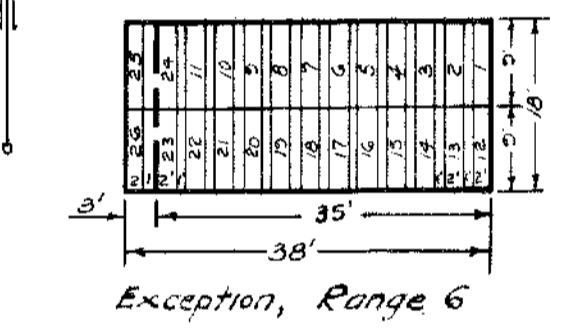
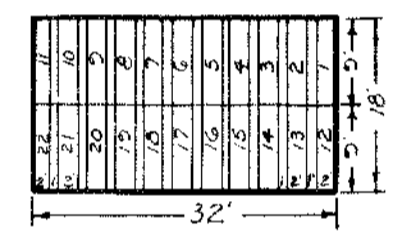
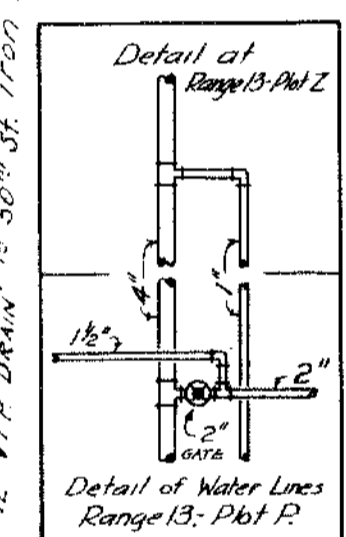

**SECTION 19**  
**CALVARY CEMETERY**  
**ST. SEBASTIAN DIVISION**

Scale: 1" = 40'



May 10, 1943.

This map supersedes former map of this section dated 1896

*Alfred J. Dineen*  
Managing Director

*Harry J. Naulon*  
Superintendent

*John J. Kearney*  
Chief Cemetery Clerk

*H. T. Manna*  
Asst. Engineer

V.L. ANDREWS, Asst. Eng. Revised: March - 1952.

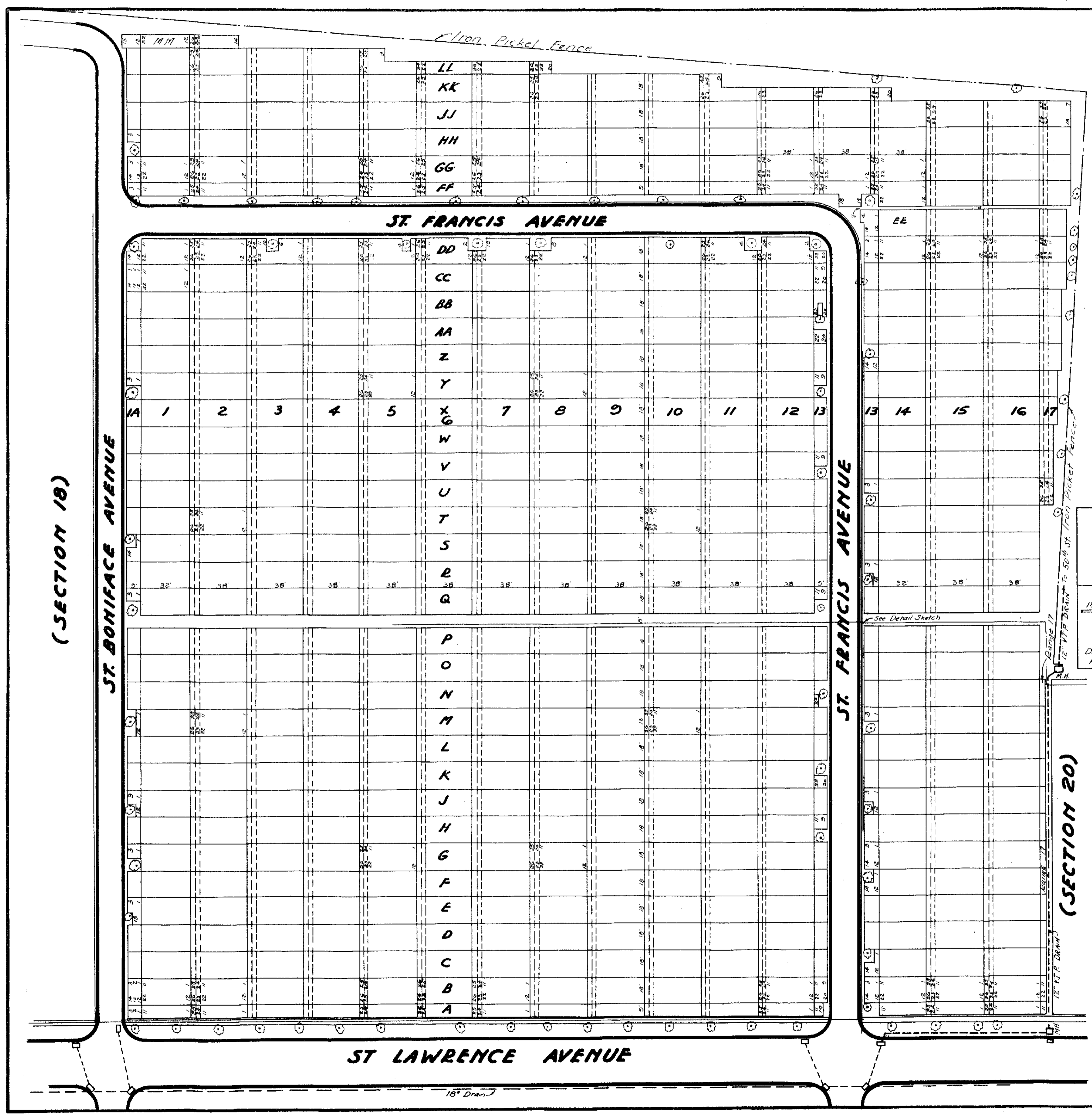

(SECTION 18)

(SECTION 20)