

Note:  
Vertical columns called Ranges are numbered 1 to 40. Ranges are subdivided into Plots lettered A to Q, J being omitted. A full plot measures 18' x 16' and contains 16 graves, each grave 9' x 3' with the exception of 35-Q, 36-Q, and 37-Q, each of which measures 18' by 18' and contains 12 graves, each grave 9' x 3' and half of Plot Q in Range 34 which contains six 9' x 3' graves.  
The 36' x 9' Plots are not designated by a Range, but are numbered 1 to 25 and 42 to 61. A full Plot contains 12 graves, numbered 1 to 12, each grave 9' x 3'.

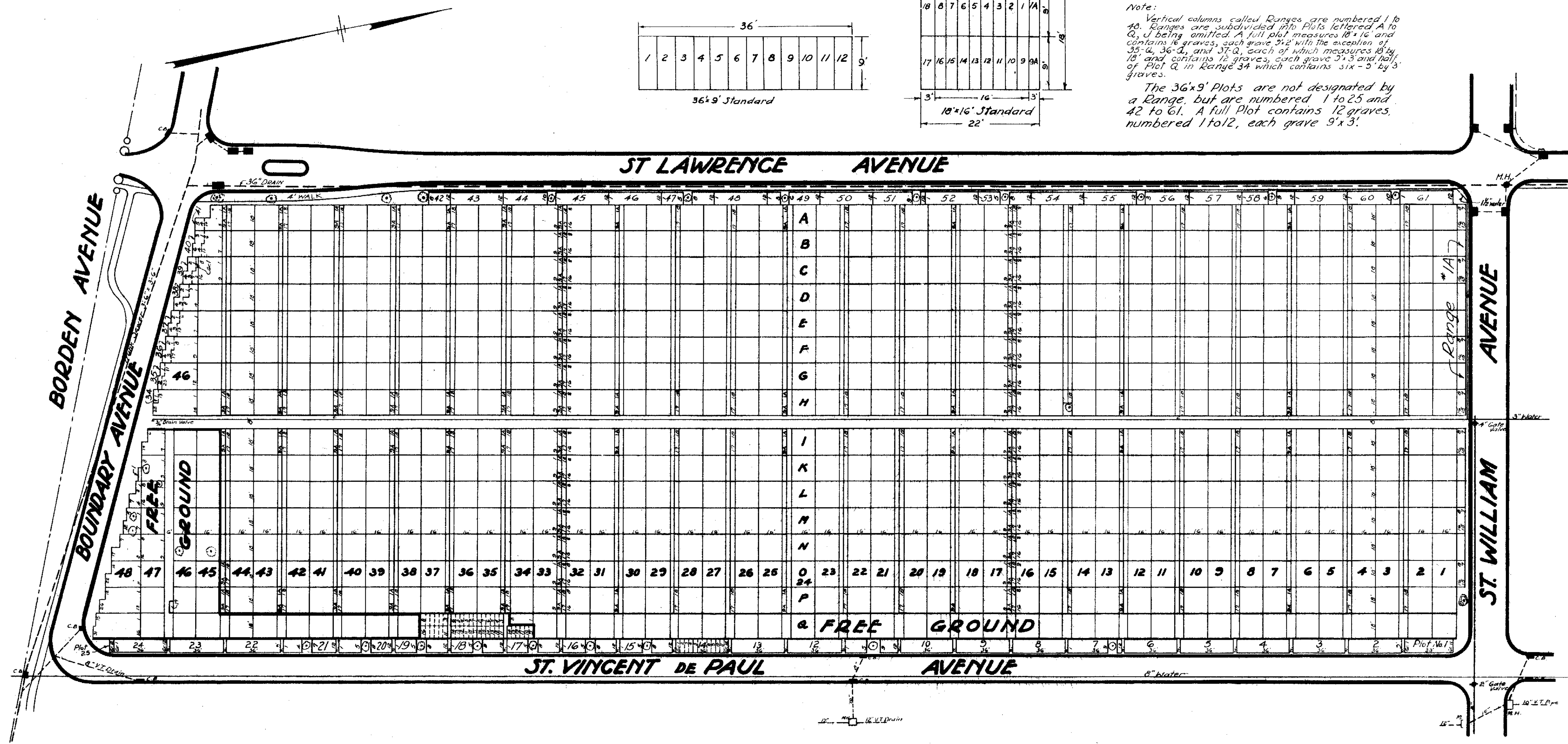

*Robert C. Dineen*  
Managing Director

*Nancy J. Haulon*  
Superintendent

*Ernest S. Griffin*  
Engineer

PROPERTY  
OF THE  
TRUSTEES OF ST. PATRICK'S CATHEDRAL  
IN THE  
CITY OF NEW YORK

New York Office - 24 East 52nd St.

**SECTION 14  
CALVARY CEMETERY  
ST. AGNES DIVISION**

Scale: 1" = 40'

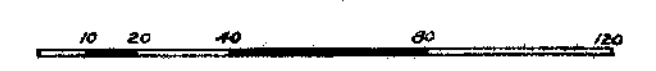

Jan. 26, 1940.

This map supersedes former map of this section dated 1896.  
Revised, May, 1946, to include additional graves Nos. 17 & 18,  
Revised, June, 1946, to include additional graves Nos. 1A & 9A.